



*Sealants and Adhesives*

# PRODUCT — CATALOGUE —

- SEALANTS
- ADHESIVES
- GLUES
- TAPES
- ACCESSORIES



[info@silicone.co.za](mailto:info@silicone.co.za) | [www.silicone.co.za](http://www.silicone.co.za)

# ABOUT US

Silicone & Technical Products (Pty) Ltd was started by Ivan and Beverley de Klerk in 1984 – Cape Town based entrepreneurs with a vision for perfection. In the ensuing 34 years the company has become a second-generation company with their son, Matthew, joining the business in 2014. Like other successful family owned manufacturing and hardware wholesale trading businesses in South Africa, the de Klerk's attribute their success to the passion and dedication of the family as well as the employees who share in the business ethos effectively transforming it into a corporate sized company where voices are heard and success is shared and celebrated with all.

Since inception in 1984, S&TP acted as representatives for Dow Corning Silicones, GE Silicones, GE Bayer Silicones, and Momentive Performance Materials. In 2009 the decision to become an independent supplier of silicone and silicone related products to the South African market allowed them to leverage expertise, products and prices from primary and secondary overseas suppliers and because of this and their manufacturing expertise in the food approved silicone product space they are seen as a first in their class independent supplier, re-packer of sealants and adhesives as well as a producer of silicone and non-silicone related chemical products in Africa.

Four branded operating divisions comprising of SILTECH sealants and adhesives, BIOSIL silicone and non-silicone based chemicals, FCD foam control dispersants and Y-CLEAN cleaning chemicals offer exceptional solution related products to all who wish to use them.

Quality Management Systems audited by the SABS encompass: ISO9001:2015 Customer Service, FSSC22000 for food safety. All the food grade products are HACCP, Kosher, Halaal approved and have FDA compliances. SANS 1828 certification is pending on Aqueous Degreasers, Concentrated All Purpose Cleaners and CIP, powdered oxygenating detergent agents, which are specifically intended for use in the food industry. NRS approved disinfectant products will be launched during that latter half of 2018 so as to bolster the Y-CLEAN brand.

Silicone & Technical Products (Pty) Ltd operates out of Cape Town as head office as well as Johannesburg and Durban. The team comprises of around 80 staff members and is an equal opportunity company with codes of Conduct and Ethics as drivers.

The focused policies of providing excellent customer service, quality products as well as industry experience and expertise will dominate their landscape as they strive for innovation to be market leaders in the core areas in which they operate but continuing to build and invest in the team, the products and the processes that hold them together as a unit.



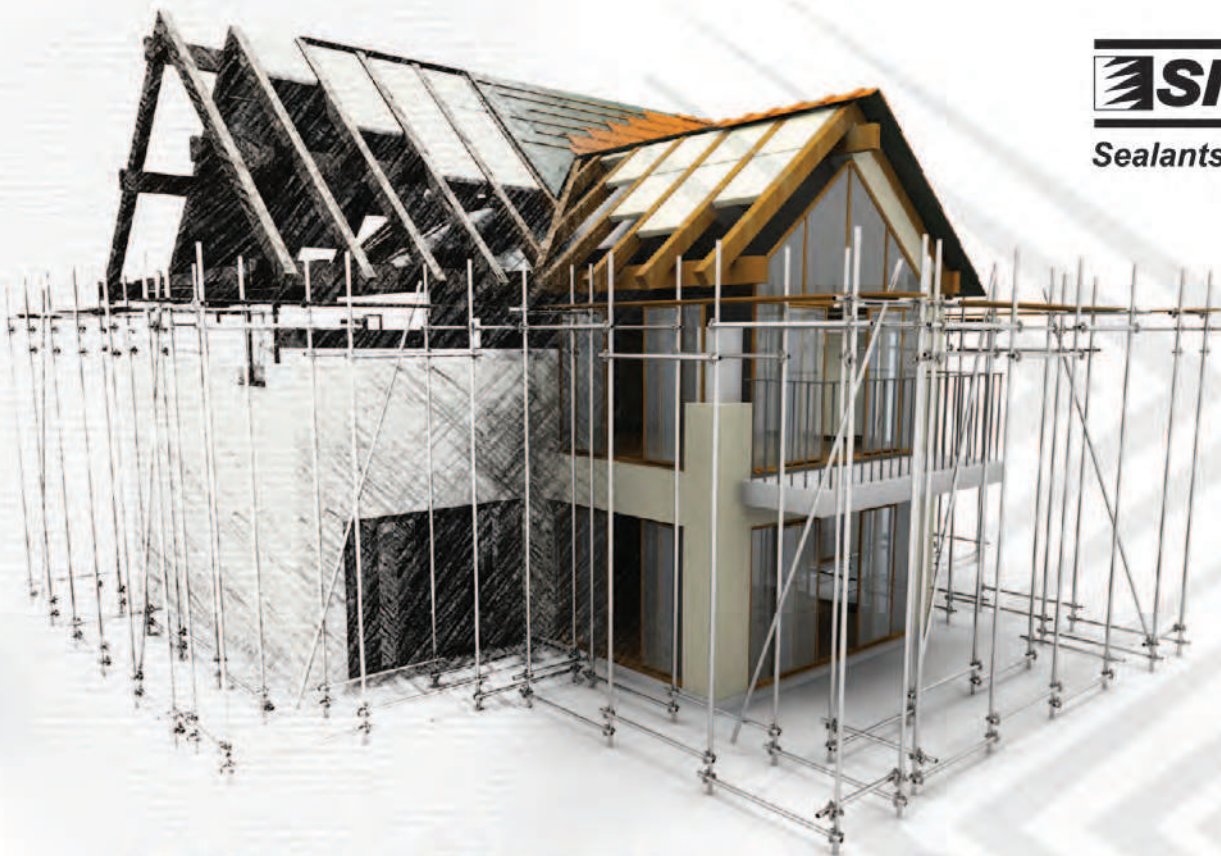

# NEED IT SEALED?

OUR PRODUCTS GETS THE JOB DONE!

Our range of purposefully designed silicone, acrylic and PU joint sealants, crack fillers, superglues, polyurethane foams as well as cornice glues and silicone lubricants get the job done no matter what.

Designed to be perfect for cement-based building materials, brick, ceramic, marble, glass, wood, galvanised steel, aluminium and most plastic surfaces, our industrial or DIY silicone and polyurethane products comes in a variety of shore hardness and colours.



# ACETOXY SEALANTS

**SILTECH 100 - CLEAR**



280ml General purpose acetoxy anti-fungal silicone sealant  
**SKU: HU0101 (25/BOX)**

**SILTECH 100 - WHITE**



280ml General purpose acetoxy anti-fungal silicone sealant  
**SKU: HU0102 (25/BOX)**

**SILTECH 100 - GREY**



280ml General purpose acetoxy anti-fungal silicone sealant  
**SKU: HU0104 (25/BOX)**

**SILTECH 100 - BRONZE**



280ml General purpose acetoxy anti-fungal silicone sealant  
**SKU: HU0105 (25/BOX)**

**SILTECH 100 - BLACK**



280ml General purpose acetoxy anti-fungal silicone sealant  
**SKU: HU0103 (25/BOX)**

**SILTECH 300 - RED**



280ml High temperature acetoxy silicone sealant  
**SKU: HU0150 (25/BOX)**

**SILTECH 1000 - CLEAR**



260ml General purpose acetoxy anti-fungal silicone sealant  
**SKU: HU0280 (25/BOX)**

**SILTECH 1000 - WHITE**



260ml General purpose acetoxy anti-fungal silicone sealant  
**SKU: HU0281 (25/BOX)**

**SILTECH 1000 - GREY**



260ml General purpose acetoxy anti-fungal silicone sealant  
**SKU: HU0283 (25/BOX)**

**SILTECH 1000 - BLACK**



260ml General purpose acetoxy anti-fungal silicone sealant  
**SKU: HU0282 (25/BOX)**

**SILTECH HOUSE - CLEAR**



280ml DIY acetoxy silicone sealant  
**SKU: HU0191 (25/BOX)**

**SILTECH BATH - WHITE**



280ml DIY acetoxy silicone sealant  
**SKU: HU0192 (25/BOX)**

**SILTECH AUTO - BLACK**



280ml DIY acetoxy silicone sealant  
**SKU: HU0193 (25/BOX)**

**SILTECH MARINE - CLEAR**



280ml DIY acetoxy silicone sealant  
**SKU: HU0190 (25/BOX)**





**Sealants and Adhesives**



**Siltech – PU40 is a single-component, moisture curing, polyurethane-based sealant material which is thixotropic and easily applied by a cartridge gun. Siltech – PU40 cures to a paintable, weather & water resistant, permanent elasticity sealant without affecting its volume**

**Very flexible and durable | Provide good impact resistance | Vary in degree of resistance to heat and chemicals | Paintable, weather & water resistant | Permanent elasticity without affecting volume | Available in white, grey and black**

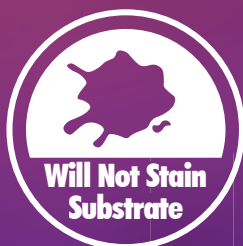



# NEUTRAL OXIME & PU SEALANTS

## NEUTRAL OXIME SILICONE SEALANTS

**SILTECH 600 - BLACK**



280ml Universal  
neutral silicone sealant  
**SKU: HU0217 (25/BOX)**

**SILTECH 600 - GREY**



280ml Universal  
neutral silicone sealant  
**SKU: HU0218 (25/BOX)**

**SILTECH 600 - WHITE**



280ml Universal  
neutral silicone sealant  
**SKU: HU0216 (25/BOX)**

**SILTECH 600 - CLEAR**



280ml Universal  
neutral silicone sealant  
**SKU: HU0215 (25/BOX)**

**SILTECH 600 - BRONZE/  
LIGHT BRONZE**



280ml Universal  
neutral silicone sealant  
**SKU: HU0219 (25/BOX)**  
**SKU: PA1086 (25/BOX)**

**SILTECH 600 - CHARCOAL**



280ml Universal  
neutral silicone sealant  
**SKU: PA1087 (25/BOX)**

## POLYURETHANE SEALANTS - CARTRIDGES

**PU 25 - BLACK**



300ml Single  
component moisture  
curing polyurethane  
sealant 25 shore  
**SKU: SE0003 (25/BOX)**

**PU 25 - GREY**



300ml Single  
component moisture  
curing polyurethane  
sealant 25 shore  
**SKU: SE0002 (25/BOX)**

**PU 25 - WHITE**



300ml Single  
component moisture  
curing polyurethane  
sealant 25 shore  
**SKU: SE0001 (25/BOX)**

**PU 40 - BLACK**



300ml Single  
component moisture  
curing polyurethane  
sealant 40 shore  
**SKU: SE0007 (25/BOX)**

**PU 40 - GREY**



300ml Single  
component moisture  
curing polyurethane  
sealant 40 shore  
**SKU: SE0006 (25/BOX)**

**PU 40 - WHITE**



300ml Single  
component moisture  
curing polyurethane  
sealant 40 shore  
**SKU: SE0005 (25/BOX)**

## POLYURETHANE SEALANT - SAUSAGES

**PU 25 - BLACK**



600ml Single  
component moisture  
curing polyurethane  
sealant 25 shore  
**SKU: SE0015 (20/BOX)**

**PU 25 - GREY**



600ml Single  
component moisture  
curing polyurethane  
sealant 25 shore  
**SKU: SE0014 (20/BOX)**

**PU 25 - WHITE**



600ml Single  
component moisture  
curing polyurethane  
sealant 25 shore  
**SKU: SE0013 (20/BOX)**

**PU 40 - BLACK**



600ml Single  
component moisture  
curing polyurethane  
sealant 40 shore  
**SKU: SE0019 (20/BOX)**

**PU 40 - GREY**



600ml Single  
component moisture  
curing polyurethane  
sealant 40 shore  
**SKU: SE0018 (20/BOX)**

**PU 40 - WHITE**



600ml Single  
component moisture  
curing polyurethane  
sealant 40 shore  
**SKU: SE0017 (20/BOX)**



# ACRYLIC SEALANTS & PROMO BUNDLES

## ACRYLIC SEALANTS (PAINTABLE)

**SILTECH 900 - WHITE**



280ml Water based paintable acrylic sealant  
**SKU: AC0002 (25/BOX)**

**SILTECH 9000 - WHITE**



260ml Water based acrylic sealant  
**SKU: AC0015 (25/BOX)**

## PROMO BUNDLES

**SILTECH 1000 - WHITE**



Siltech 1000 White 3pk  
**SKU: AF0061)**

**SILTECH 1000 - CLEAR**



Siltech 1000 Clear 3pk  
**SKU: AF0052**

**SILTECH 9000**



Siltech 9000 Water-based acrylic Sealant 3pk  
**SKU: AF0044**

**Siltech 9000 & Cartridge**



Siltech 9000 & Cartridge Gun 2pk  
**SKU: AF0032**

## ITEMS AVAILABLE IN

- Siltech 1000 - White 3pk
- Siltech 1000 - Clear 3pk
- Siltech 9000 - Water based acrylic sealant 3pk
- Siltech 9000 & Cartridge Gun 2pk





# **DON'T CUT 'CORNICE' DO THE JOB PROPERLY THE FIRST TIME**

**SILTECH 800 IS A FLEXIBLE POLYSTYRENE CORNICE ADHESIVE THAT CAN BE USED ON DECORATIVE PLASTER PIECES, CEILING ROSES AND REINFORCE PLASTERBOARD WITH SUCH EASE THAT EVEN THE DIY ENTHUSIAST CAN ACHIEVE A PROFESSIONAL FINISH. PRODUCT EXHIBITS EXCELLENT FILLING AND PAINTABLE PROPERTIES.**

These include; concrete, masonry, glass, aluminium, glaze tiles, metals, painted or treated wooden surfaces and untreated wood.

What's more, it comes in a range of sizes to suit your needs, both in cartridge form, for smaller jobs, as well as 1 litre/kg, 2 litre/kg, 5 litre/kg tubs for larger projects.



# CORNICE ADHESIVES

## CORNICE ADHESIVES FLEXIBLE

### SILTECH 800 - WHITE



1kg Water based  
paintable cornice adhesive

**SKU: AC0030**

### SILTECH 800 - WHITE



2kg Water based  
paintable cornice adhesive

**SKU: AC0061**

### SILTECH 800 - WHITE



5kg Water based  
paintable cornice adhesive

**SKU: AC0062**

### SILTECH 800 - WHITE



10kg Water based  
paintable cornice adhesive

**SKU: AC0063**

### SILTECH 800 - WHITE



1l Water based  
paintable cornice adhesive

**SKU: AC0017**

### SILTECH 800 - WHITE



2.5l Water based  
paintable cornice adhesive

**SKU: AC0055**

### SILTECH 800 - WHITE



5l Water based  
paintable cornice adhesive

**SKU: AC0045**

### SILTECH 800 - WHITE



310ml Water based  
paintable cornice adhesive

**SKU: AC0021 (25/BOX)**

## ECONO-CORNICE ADHESIVES SANDABLE

### SILTECH 400 - WHITE



1kg Water based  
paintable cornice adhesive

**SKU: AQ0063**

### SILTECH 400 - WHITE



2kg Water based  
paintable Econo-cornice adhesive

**SKU: AQ0531**

### SILTECH 400 - WHITE



5kg Water based  
paintable Econo-cornice adhesive

**SKU: AQ0533**

### SILTECH 400 - WHITE



260ml Water based  
paintable Econo-cornice adhesive

**SKU: AC0012**

# SKIRTING ADHESIVES

## SKIRTING ADHESIVES SANDABLE

SILTECH 200 - WHITE



1kg Water based paintable skirting adhesive

SKU: AC0102

SILTECH 200 - WHITE



2kg Water based paintable skirting adhesive

SKU: AC0102

SILTECH 200 - WHITE



5kg Water based paintable skirting adhesive

SKU: AC0103

SILTECH 200 - WHITE



260ml Water based paintable skirting adhesive

SKU: AC0100



SILTECH 400

### Econo-Cornice Adhesive

Siltech 400 is a specially formulated ready to use rigid acrylic based sandable adhesive suitable for use on decorative polystyrene and polyurethane cornices, ceiling roses as well as small plaster board mouldings and is ideal for use by a DIY enthusiast as well as professional contractors.



SILTECH 800

### Cornice Adhesive

Siltech 800 is a specially formulated ready to use flexible acrylic based sealant/adhesive suitable for use on decorative polystyrene and polyurethane cornices, ceiling roses as well as small plaster board mouldings and is ideal for use by a DIY enthusiast as well as professional contractors.



SILTECH 200

### Skirting Adhesive

Siltech 200 is a specially formulated acrylic based adhesive suitable for use on all wooden and PVC skirting boards.



# OTHER RELATED PRODUCTS

## HYBRID SEALANTS/CONSTRUCTION ADHESIVES

**SILTECH 60 - GREY**



280ml Kwik-stick hybrid construction adhesive

**SKU: HU0116 (25/BOX)**

**SILTECH 60 - WHITE**



280ml Kwik-stick hybrid construction adhesive

**SKU: HU0117 (25/BOX)**

## PU (POLYURETHANE) FOAM

**SILTECH 4000**



750ml Silfoam polyurethane foam

**SKU: SI0003 (12/BOX)**

**SILTECH 4000**



500ml Silfoam polyurethane foam

**SKU: SI0002 (12/BOX)**

## NON-SETTING MASTIC

**SILTECH 700 - WHITE**



280ml Non-Setting Mastic

**SKU: PE0010 (25/BOX)**

**SILTECH 700 - GREY**



280ml Non-Setting Mastic

**SKU: PE0011 (25/BOX)**

## SILICONE, CAULKING GUNS & SILICONE SPRAY

**12" BULK FILL GUN**



**SKU: SI0125**

**SILICONE GUN (RED PLASTIC)**



**SKU: SI0037**

**GUN CAULKING (HEAVY DUTY)**



**SKU: SI0034**

**SILICONE SPRAY**



400ml Suprasil silicone spray  
**SKU: DY0001 (12/BOX)**

# EASY SQUEEZY

## EASY SQUEEZY DIY ACETOXY SEALANTS

### EASY SQUEEZY BATH - WHITE



90ml DIY acetoxy  
silicone sealant  
sausage  
**SKU: HU0251**  
(36/BOX)

### EASY SQUEEZY MARINE - CLEAR



90ml DIY acetoxy  
silicone sealant  
sausage  
**SKU: HU0250**  
(36/BOX)

### EASY SQUEEZY AUTO - BLACK



90ml DIY acetoxy  
silicone sealant  
sausage  
**SKU: HU0252**  
(36/BOX)

### EASY SQUEEZY HI-TEMP - RED



90ml DIY acetoxy  
silicone sealant  
sausage  
**SKU: HU0253**  
(36/BOX)

### COUNTER STAND



Easy Squeezy  
counter display  
units  
**SKU: MA0002**

### DISPLAY STAND



Easy Squeezy  
Metal Floorstand  
**SKU: MA0005**



### EASY TO USE SILICONE

- No silicone gun required
- Easy to use and store
- Less silicone wasted
- Minimal packaging waste
- A South African first!

### FOUR TYPES AVAILABLE

- Bath silicone - white
- Marine silicone - clear
- Auto silicone - black
- Hi-temp gasket silicone - red



### BATH White Silicone



### MARINE Clear Silicone



### AUTO Black Silicone



### HI-TEMP Red Gasket Silicone



# THE SEALANT & ADHESIVE Specialists



	Polyurethane	Hybrid	Silicone	Skirting	Silicone	Cornice	Silicone	Mastic	Cornice	Acrylic	Silicone	Acrylic	Silicone	Silicone	Silicone	Silicone
	PU25/PU40	Siltech 60 Kwik-Stick	Siltech 100	Siltech 200	Siltech 300 HT	Siltech 400	Siltech 600 NX	Siltech 700	Siltech 800	Siltech 900	Siltech 1000	Siltech 9000	Siltech Marine	Siltech Auto	Siltech House	Siltech Bath
	300ml-600ml	280ml	280ml	260ml	280ml	260ml	280ml	280ml	310ml	280ml	260ml	260ml	280ml	280ml	280ml	280ml
Properties	Single component Polyurethane sealant	Hybrid Adhesive	Professional Acrylic Silicone	Sealable Skirting Adhesive	High Temperature Acrylic Silicone	Sealable Cornice Adhesive	Neutral Curing Silicone	New Setting Mastic	Flexible Cornice Adhesive	Professional Paintable Acrylic	EP Acrylic Silicone	EP Paintable Acrylic	DIV Acrylic Silicone Sealant	DIV Acrylic Silicone Sealant	DIV Acrylic Silicone Sealant	DIV Acrylic Silicone Sealant
Curing system	Atmospheric	Hybrid	Acetony	Water Based	Acetony	Water Based	Neutral	oil based	Water Based	Water Based	Acetony	Water Based	Acetony	Acetony	Acetony	Acetony
Tensile strength (MPa)	6.5	2.8	2.0	≥0.1	2.4	≥0.1	1.0	≥0.08	≥0.1	2.0	≥0.1	2.0	2.0	2.0	2.0	2.0
Shore A hardness	20 ± 5	60 ± 5	17	>100%	25	>100%	20	30	30-40	17	30-40	17	30-40	17	17	17
Elongation at break (%)	>600%	>570%	>570%	>100%	475%	>100%	500%	>250%	>100%	>570%	>570%	>100%	570%	570%	570%	570%
Movement accommodation	-	15%	±25%	-	-	-	>50%	<5	±10%	12%	±25%	12%	-	-	-	-
Application temperature	+5°C to +35°C	+5°C to +40°C	+5°C to +40°C	+5°C to +40°C	-10°C to +50°C	+5°C to +40°C	+5°C to +40°C	-20°C to +70°C	+5°C to +40°C	+5°C to +40°C	+5°C to +40°C	+5°C to +40°C	+5°C to +40°C	+5°C to +40°C	+5°C to +40°C	+5°C to +40°C
Temperature resistance	-30°C to +80°C	-20°C to +80°C	-40°C to +100°C	-30°C to +80°C	-40°C to +260°C	-30°C to +80°C	-5°C to +100°C	n/a	-30°C to +80°C	-20°C to +70°C	-40°C to +100°C	-20°C to +70°C	-40°C to +100°C	-40°C to +100°C	-40°C to +100°C	-40°C to +100°C
Shrinkage (30 days) (%)	-	30% - 32%	30% - 32%	29%	-	29%	20%	<10%	30%	29%	30% - 32%	29%	-	-	-	-
Touch free time (surface dry time)	60 min - 90 min	-	10 min - 15 min	15 min - 60 min	18 min	15 min - 60 min	15 min	18-24 hours	20 min - 60 min	15 min - 60 min	10 min - 15 min	15 min - 60 min	-	-	-	-
Tooling time	-	-	<15 min	<15 min	-	<15 min	8 min	1hour	<20 min	<15 min	<15 min	<15 min	-	-	-	-
Density (g/cm³)	1.15 ± 0.03	-	0.96-0.97	1.90	1.02	1.90	0.99	1.5	1.58	1.64	0.96-0.97	1.64	-	-	-	-
Skin over time (25°C @ 40% RH)	-	5 min - 10 min	15 min	30 min	10 min	30 min	±10 min	18-24 hours	30 min	30 min	15 min	30 min	15 min	15 min	15 min	15 min
Cure rate/time*	2/24 hours	2.5mm/day	12-24 hours	2mm/24 hours	3.1mm/day	2mm/24 hours	1-2 days	48 hours	24 hours	24 hours	12-24 hours	24 hours	2mm/day	2mm/72 hours	2mm/day	2mm/day
Shelf life (months)	12	9	18	12	12	12	12	9	12	12	18	12	18	18	18	18
Sealant Selection	✓	↔	✓	✓	✓	✓	✓	✓	✓	✓	✓	✓	✓	✓	✓	✓
Glass glazing	✓	↔	✓	✓	✓	✓	✓	✓	✓	✓	✓	✓	✓	✓	✓	✓
Glass lamination	✓	↔	✓	✓	✓	✓	✓	✓	✓	✓	✓	✓	✓	✓	✓	✓
Polymerized glazing	✓	↔	✓	✓	✓	✓	✓	✓	✓	✓	✓	✓	✓	✓	✓	✓
Structural glazing	✓	↔	✓	✓	✓	✓	✓	✓	✓	✓	✓	✓	✓	✓	✓	✓
Plaster joints	✓	↔	✓	✓	✓	✓	✓	✓	✓	✓	✓	✓	✓	✓	✓	✓
Expansion joints - vertical & horizontal	✓	↔	✓	✓	✓	✓	✓	✓	✓	✓	✓	✓	✓	✓	✓	✓
Expansion joints - traffic	✓	↔	✓	✓	✓	✓	✓	✓	✓	✓	✓	✓	✓	✓	✓	✓
Precast concrete	✓	↔	✓	✓	✓	✓	✓	✓	✓	✓	✓	✓	✓	✓	✓	✓
Curbs and walls	✓	↔	✓	✓	✓	✓	✓	✓	✓	✓	✓	✓	✓	✓	✓	✓
Cladding panels	✓	↔	✓	✓	✓	✓	✓	✓	✓	✓	✓	✓	✓	✓	✓	✓
Roofing	✓	↔	✓	✓	✓	✓	✓	✓	✓	✓	✓	✓	✓	✓	✓	✓
Minor tiling	✓	↔	✓	✓	✓	✓	✓	✓	✓	✓	✓	✓	✓	✓	✓	✓
Bath / shower / kitchen	✓	↔	✓	✓	✓	✓	✓	✓	✓	✓	✓	✓	✓	✓	✓	✓
Aquarium / fish tanks	✓	↔	✓	✓	✓	✓	✓	✓	✓	✓	✓	✓	✓	✓	✓	✓
Ducting	✓	↔	✓	✓	✓	✓	✓	✓	✓	✓	✓	✓	✓	✓	✓	✓
Draught proofing	✓	↔	✓	✓	✓	✓	✓	✓	✓	✓	✓	✓	✓	✓	✓	✓
Ceramics / skirting boards	✓	↔	✓	✓	✓	✓	✓	✓	✓	✓	✓	✓	✓	✓	✓	✓
Pipe / cable entries	✓	↔	✓	✓	✓	✓	✓	✓	✓	✓	✓	✓	✓	✓	✓	✓
Fire assembly	✓	↔	✓	✓	✓	✓	✓	✓	✓	✓	✓	✓	✓	✓	✓	✓
Fire seals & high temp + 250°C	✓	↔	✓	✓	✓	✓	✓	✓	✓	✓	✓	✓	✓	✓	✓	✓
Refrigeration	✓	↔	✓	✓	✓	✓	✓	✓	✓	✓	✓	✓	✓	✓	✓	✓
Cold room panels	✓	↔	✓	✓	✓	✓	✓	✓	✓	✓	✓	✓	✓	✓	✓	✓
Construction adhesive	✓	↔	✓	✓	✓	✓	✓	✓	✓	✓	✓	✓	✓	✓	✓	✓
Colours Available	✓	✓	✓	✓	✓	✓	✓	✓	✓	✓	✓	✓	✓	✓	✓	✓
Clear	✓	✓	✓	✓	✓	✓	✓	✓	✓	✓	✓	✓	✓	✓	✓	✓
White	✓	✓	✓	✓	✓	✓	✓	✓	✓	✓	✓	✓	✓	✓	✓	✓
Black	✓	✓	✓	✓	✓	✓	✓	✓	✓	✓	✓	✓	✓	✓	✓	✓
Grey	✓	✓	✓	✓	✓	✓	✓	✓	✓	✓	✓	✓	✓	✓	✓	✓
Bronze	✓	✓	✓	✓	✓	✓	✓	✓	✓	✓	✓	✓	✓	✓	✓	✓
Aluminium	✓	✓	✓	✓	✓	✓	✓	✓	✓	✓	✓	✓	✓	✓	✓	✓
Brown	✓	✓	✓	✓	✓	✓	✓	✓	✓	✓	✓	✓	✓	✓	✓	✓
Red	✓	✓	✓	✓	✓	✓	✓	✓	✓	✓	✓	✓	✓	✓	✓	✓
Surface - Conditions	✓	✓	✓	✓	✓	✓	✓	✓	✓	✓	✓	✓	✓	✓	✓	✓
Dry	✓	✓	✓	✓	✓	✓	✓	✓	✓	✓	✓	✓	✓	✓	✓	✓
Damp	✓	✓	✓	✓	✓	✓	✓	✓	✓	✓	✓	✓	✓	✓	✓	✓
Wet	✓	✓	✓	✓	✓	✓	✓	✓	✓	✓	✓	✓	✓	✓	✓	✓
Under water	✓	✓	✓	✓	✓	✓	✓	✓	✓	✓	✓	✓	✓	✓	✓	✓
Oil	✓	✓	✓	✓	✓	✓	✓	✓	✓	✓	✓	✓	✓	✓	✓	✓
Bismen	✓	✓	✓	✓	✓	✓	✓	✓	✓	✓	✓	✓	✓	✓	✓	✓
Paintable	✓	✓	✓	✓	✓	✓	✓	✓	✓	✓	✓	✓	✓	✓	✓	✓
Mold resistant	✓	✓	✓	✓	✓	✓	✓	✓	✓	✓	✓	✓	✓	✓	✓	✓
Surface - Construction	✓	✓	✓	✓	✓	✓	✓	✓	✓	✓	✓	✓	✓	✓	✓	✓
Glass	✓	✓	✓	✓	✓	✓	✓	✓	✓	✓	✓	✓	✓	✓	✓	✓
Concrete / plaster / cement	✓	✓	✓	✓	✓	✓	✓	✓	✓	✓	✓	✓	✓	✓	✓	✓
Limestone	✓	✓	✓	✓	✓	✓	✓	✓	✓	✓	✓	✓	✓	✓	✓	✓
Marble / granite	✓	✓	✓	✓	✓	✓	✓	✓	✓	✓	✓	✓	✓	✓	✓	✓
Brick	✓	✓	✓	✓	✓	✓	✓	✓	✓	✓	✓	✓	✓	✓	✓	✓
Glazed tiles	✓	✓	✓	✓	✓	✓	✓	✓	✓	✓	✓	✓	✓	✓	✓	✓
Bismen / asphalt	✓	✓	✓	✓	✓	✓	✓	✓	✓	✓	✓	✓	✓	✓	✓	✓
Wood untreated	✓	✓	✓	✓	✓	✓	✓	✓	✓	✓	✓	✓	✓	✓	✓	✓
Wood painted	✓	✓	✓	✓	✓	✓	✓	✓	✓	✓	✓	✓	✓	✓	✓	✓
Aluminium - milled	✓	✓	✓	✓	✓	✓	✓	✓	✓	✓	✓	✓	✓	✓	✓	✓
Aluminium - anodized	✓	✓	✓	✓	✓	✓	✓	✓	✓	✓	✓	✓	✓	✓	✓	✓
Aluminium - coated	✓	✓	✓	✓	✓	✓	✓	✓	✓	✓	✓	✓	✓	✓	✓	✓
Stainless steel	✓	✓	✓	✓	✓	✓	✓	✓	✓	✓	✓	✓	✓	✓	✓	✓
MM / galvanized steel	✓	✓	✓	✓	✓	✓	✓	✓	✓	✓	✓	✓	✓	✓	✓	✓
Chromadeel	✓	✓	✓	✓	✓	✓	✓	✓	✓	✓	✓	✓	✓	✓	✓	✓
Copper	✓	✓	✓	✓	✓	✓	✓	✓	✓	✓	✓	✓	✓	✓	✓	✓
Brass	✓	✓	✓	✓	✓	✓	✓	✓	✓	✓	✓	✓	✓	✓	✓	✓
Lead	✓	✓	✓	✓	✓	✓	✓	✓	✓	✓	✓	✓	✓	✓	✓	✓
Zinc	✓	✓	✓	✓	✓	✓	✓	✓	✓	✓	✓	✓	✓	✓	✓	✓
Painted coated metals (Gen)	✓	✓	✓	✓	✓	✓	✓	✓	✓	✓	✓	✓	✓	✓	✓	✓
Surface - Others	✓	✓	✓	✓	✓	✓	✓	✓	✓	✓	✓	✓	✓	✓	✓	✓
Polycarbonate	↔	✓	↔	✓	↔	✓	✓	✓	✓	✓	✓	✓	↔	↔	↔	↔
PVC	↔	✓	↔	✓	↔	✓	✓	✓	✓	✓	✓	✓	↔	↔	↔	↔
Glass reinforced polyester	↔	✓	↔	✓	↔	✓	✓	✓	✓	✓	✓	✓	↔	↔	↔	↔
Polyester	↔	✓	↔	✓	↔	✓	✓	✓	✓	✓	✓	✓	↔	↔	↔	↔
ABS	↔	✓	↔	✓	↔	✓	✓	✓	✓	✓	✓	✓	↔	↔	↔	↔
Teflon	↔	✓	↔	✓	↔	✓	✓	✓	✓	✓	✓	✓	↔	↔	↔	↔
Polyethylene	↔	✓	↔	✓	↔	✓	✓	✓	✓	✓	✓	✓	↔	↔	↔	↔

## Surface Preparation for Sealant Adhesion

The use of proper materials and the following cleaning procedures are critical for sealant adhesion. No sealant will maintain long-term adhesion to any substrate if the surface is not cleaned and/or prepared properly before the sealant is applied.

1. Always use clean, fresh solvent as recommended by Momentive Performance Materials in the adhesion test report.

Commonly used solvents for cleaning substrates prior to wet sealing with silicone are:

- Isopropyl Alcohol (IPA) - Only pure industrial grade IPA shall be used (99.5% wt, purity)
- Methyl Ethyl Ketone (MEK)
- Xylene
- Toluene
- Acetone

2. Always use clean, white, lint-free cloths, or other approved wiping materials.
3. Always use clean, narrow-blade putty knife, or similar.

The above solvents are suggested only as readily available and commonly used materials. With each specific application, the end user must determine the effectiveness of each particular combination of solvent/substrate and sealant chosen. As always adhesion testing is recommended prior to sealing.

## Recommended Cleaning Procedures

1. Remove all loose material such as dirt and dust, plus any oil, fat, and other contaminants from the substrates where structural silicone adhesion is required.
2. Clean surface using a "two rag wipe" technique: Wet one cloth with solvent and wipe the entire surface once, then with a second cloth, wipe the wet solvent from the surface before it evaporates. Allowing the solvent to dry will redeposit any contaminants.
3. When cleaning deep, narrow joints, wrap the cleaning cloth around a clean, narrow-blade putty knife. This permits force to be applied to the surface to be cleaned.
4. Clean only as a much once as can be sealed in one hour.
5. Change to clean rags frequently, as they become soiled.
6. Once the surface is clean, it is important to keep it clean. Touching the surface, for example, contaminates the surface and requires the cleaning procedure to be repeated.
7. Keep the glazing area free of dust and do not allow dirt and debris to be deposited on the cleaned surface.
8. Keep the period of time between cleaning to the next process, i.e. priming (where required) and/or sealant application to not more than 20 minutes.

## Important Points On Using Solvents

1. Do not dip wipe cloths into solvent. This can contaminate the solvent. Pour or pump the solvent onto the cloth.
2. Always use clean containers for solvent use and for solvent storage.
3. Smoking, sparks, welding and flames of any type must not be permitted in the areas or the vicinity where solvents are being used.
4. Follow all precautions on the solvent warning label.

## Mileage - Estimating sealant requirements

Linear meters per 310ml Silicone cartridges	mm	3	4	6	8	10	12	15	20	25
	4	25	18	13	10	7	6	5	3.5	-
	5	20	15	10	7	6	5	4	3	-